

JACKSON

WILLIAM

A. 46. 249

Courses & distances down
the River from the Elm to
the Elm

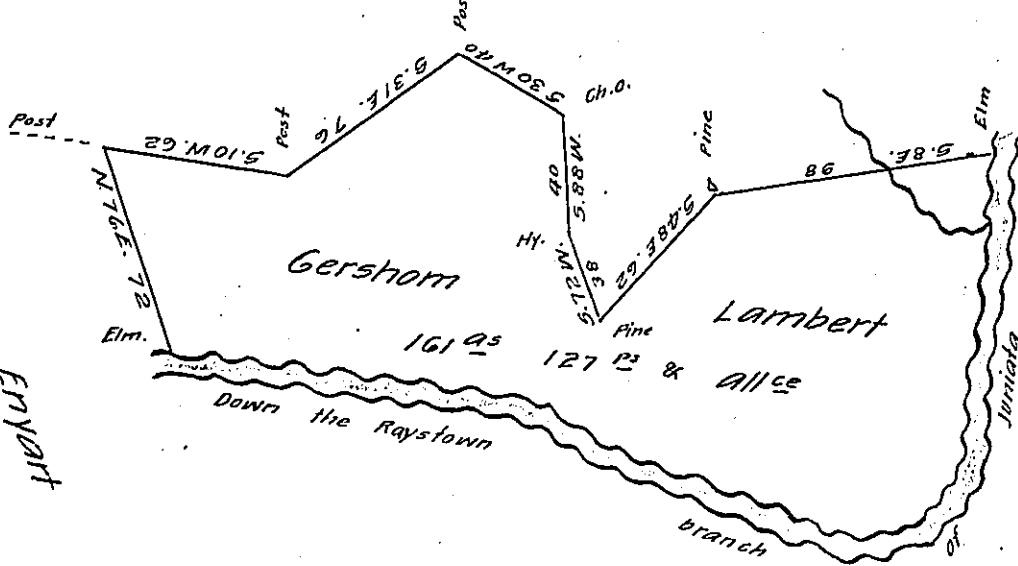

Elm N. 9 E. 124
N. 33 E. 44
N. 22 E. 79
N. 12 W. 28
N. 45 W. 22
N. 83 W. 40
N. 79 W. 75 Elm.
412

WILLIAM
ENYART

A. 46. 246

Situate in Porter Township Huntingdon County containing
one hundred sixty one acres one hundred & twenty seven perches &
allowance including an improvement & actual settlement survey'd the
25th day of March 1816 in pursuance of a Warrant Granted to
Gersthor Lambert dated March 15th 1816

Jno. Morrison D.S.

Richard T. Leech Esq.
Surveyor General

IN TESTIMONY that the above is a copy of the original remaining on file in
the Department of Internal Affairs of Pennsylvania, made
conformably to an Act of Assembly approved the 16th day of
February, 1833, I have hereunto set my Hand and caused
the Seal of said Department to be affixed at Harrisburg,
this fifteenth day of September 1905

Joseph P. Brown
Secretary of Internal Affairs.